

EXHIBIT  
A-1

85-118

PETE GARGANO - BRACCO CONST.

ACTION SURVEYING, INC.  
814 S.E. 48th LANE  
CAPE CORAL, FL. 33904

G.L. Davis, P.L.S.  
Fla. Cert. #3198

This Survey is Herby Certified to Meeting the Minimum Technical Standards Set Forth by The Florida Board of Land Surveyors Pursuant to Section 472.007 Florida Statutes.

Lot 10 Royal Palm Business Park  
As Escrowed in Plat Book 35  
Page 78 Lee County, Florida

ROYAL PALM SQUARE BLVD.

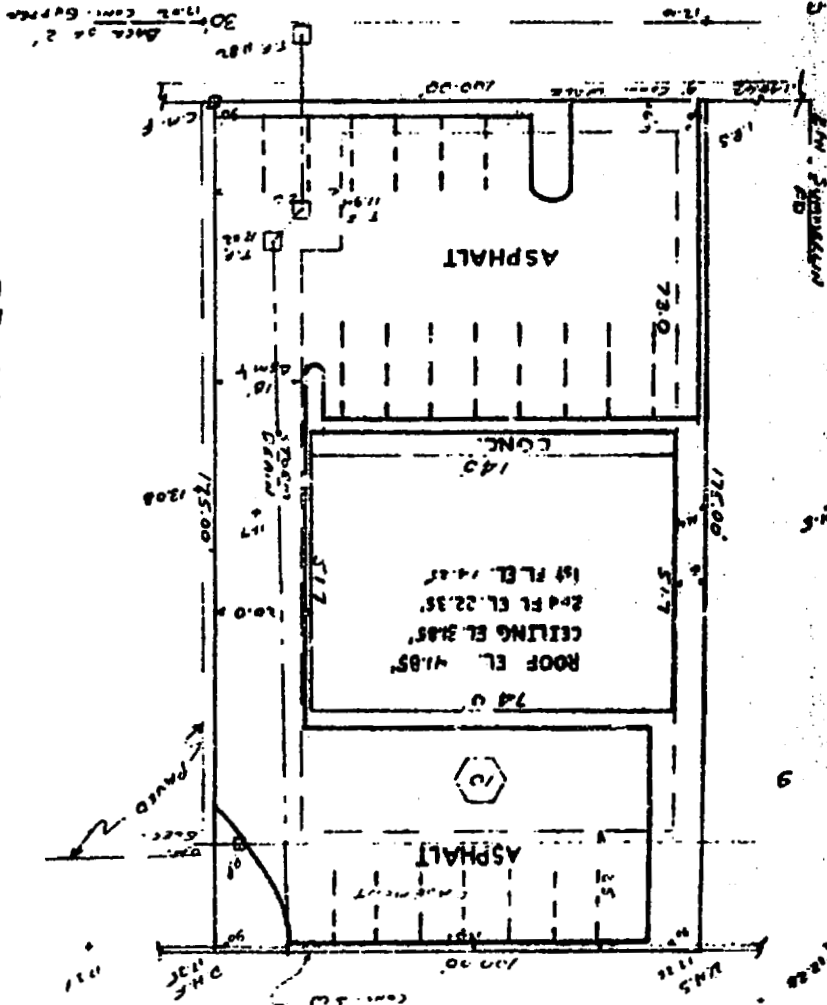

OFF REC 1820P62908

FINAL SURVEY  
NOV. 20, 1985

FOUNDATION LOCATED  
JUL. 5, 1985

TOP ABOVE  
MAY 1, 1985

SCALE 1"=30'  
JAN. 7, 1985

LAND SURVEY  
FLOOD ZONE IS

ESTIMATES: N.G.P.C.

LM&E